

Disc Spring

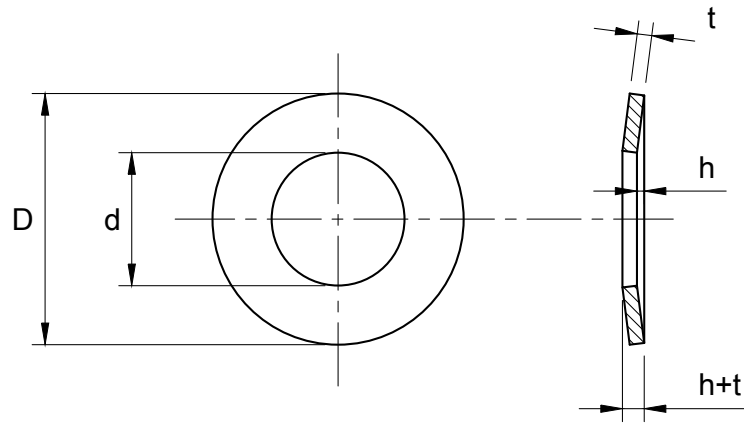

Unit : mm

Size-No.	Disc Spring				H (Heavy Duty)				L (Light Duty)				
	d		D		t		h	h+t	t		h	h+t	
	Basic	Tol.	Basic	Tol.	Basic	Tol.	Approx.	Approx.	Basic	Tol.	Approx.	Approx.	
DB-	3	3.2	+0.3 -0.1	6	±0.3	0.3	±0.03	0.2	0.5	-	-	-	-
	4	4.2		8		0.4	±0.04	0.2	0.6	0.3	±0.03	0.25	0.55
	5	5.2		10		0.5	±0.05	0.25	0.75	0.4	±0.04	0.3	0.7
	6	6.2		12.5		0.7		0.3	1	0.5		0.35	0.85
	7	7.2		14		0.8	±0.06	0.3	1.1	0.5	±0.05	0.4	0.9
	8	8.2		16		0.9		0.35	1.25	0.6		0.45	1.05
	9	9.2		18		1	±0.07	0.4	1.4	0.7	±0.06	0.5	1.2
	10	10.2		20		1		0.45	1.45	0.8		0.55	1.35
	11	11.2	+0.4 -0.1	22.5	±0.4	1.2	±0.07	0.5	1.7	0.8	±0.05	0.65	1.45
	12	12.2		25		1.5		0.55	2.05	0.9		0.7	1.6
	14	14.2	+0.5 -0.2	28	±0.5	1.5	±0.08	0.65	2.15	1	±0.06	0.8	1.8
	16	16.3		31.5		1.75		0.7	2.45	1.2		0.9	2.1
	18	18.3	+0.6 -0.4	35.5	±0.6	2	±0.1	0.8	2.8	1.2	±0.07	1	2.2
	20	20.4		40		2		0.9	2.9	1.5		1.15	2.65
	22	22.4	±0.12	45	±0.5	2.5	±0.1	1	3.5	1.75	±0.08	1.3	3.05
	25	25.4		50		3		1.1	4.1	2		1.4	3.4
	28	28.5	±0.1	56	±0.6	3	±0.12	1.3	4.3	2	±0.08	1.6	3.6
	30	31		63		3.5		1.4	4.9	2.5		1.75	4.25
	35	36	±0.15	71	±0.6	4	±0.12	1.6	5.6	2.5	±0.1	2	4.5
	40	41		80		5		1.7	6.7	3		2.3	5.3
45	46	±0.12	90	±0.7	5	±0.15	2	7	3.5	±0.12	2.5	6	
50	51		±0.7		100		±0.7	6	2.2		8.2	3.5	2.8

• Material = carbon steel Hardness = HRC40~50 Finish = black oxide or phosphate coating (ACP)